

# Signature Theatre

## THE IRENE DIAMOND STAGE

### THEATER SPECIFICATIONS

SEATING CAPACITY: 294 seats

DIMENSIONS: Stage 59' W x 35'-6" D  
Adjustable Proscenium dimensions 45' W x 20' H to 37' W x 17' H  
Distance stage to last row of seats: 45'

#### STAGE FLOOR:

- The downstage 13'- 6" of stage are Wenger platforms, which may be removed.
- Upstage 22' are two layers of ¾" plywood, on top of 2X4 sleepers, on top of neoprene pads, on top of concrete

#### FLY SYSTEM:

- 14 line sets over the upstage 15' of the deck
- Out trim for line sets 1, 2, 8-14 is 38' from deck
- Out trim for line sets 3-7 is 46' from deck
- Fly system is equipped with winches supplied by Stage Technologies

#### BACKSTAGE FACILITIES *(long-term rentals)*

- Two ADA-compliant dressing rooms included accommodating 4 to 6 people each. Rooms are equipped with mirrors, a sink, a wardrobe rack, one Equity cot, audio stage monitors, and shower/toilet in the room. Additional rooms available to rent.
- Shared green room available equipped with a fridge, sink, microwave, casual seating and video monitors.
- Shared wardrobe room included with two washer/dryer units.

---

### EQUIPMENT INCLUDED:

LIGHTING: ETC EOS console with exterior touch screen monitors  
Lighting package with approx. 180 fixtures.

SOUND: Allen & Heath console  
Pre-installed system & cabinets  
Mac Pro Q Lab computer and CD playback

*\*\* Subject to availability, there may be additional lighting and sound equipment, and accessories available for rental \*\**

COM: Riedel clear-com system  
Stage Management Control Console

MONITORS: Video feed in booth, lobby, and green room  
Audio feed to backstage, dressing rooms, and FOH  
Infrared Listening System

STAGE: 4 sets of black legs and borders, sewn flat  
1 black-out drop  
Scrim, black (available for rental)  
Cyclorama, white (available for rental)

OTHER: Assorted ladders, scaffolding, and Genie

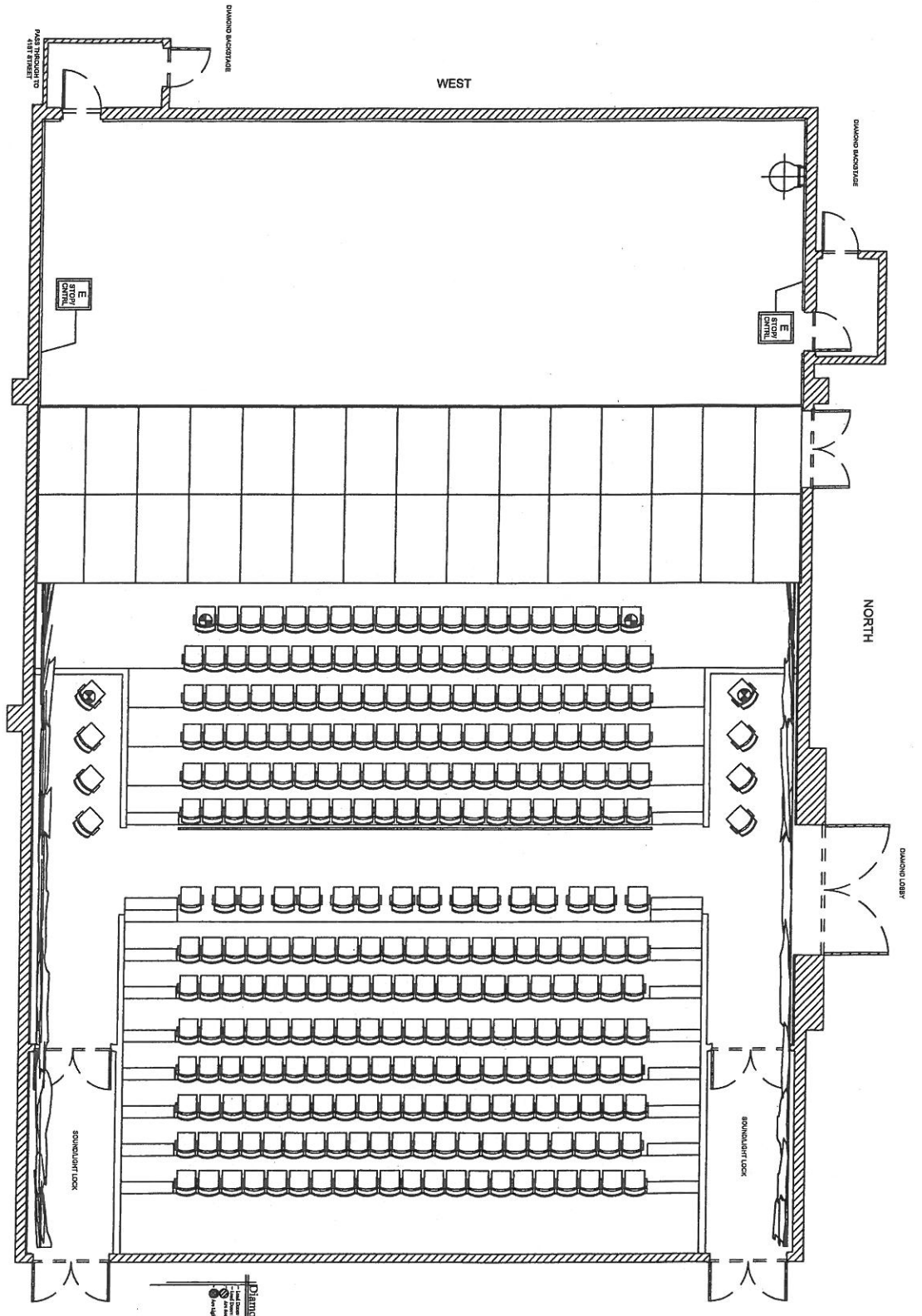

**Diamond Theatre Notes**  
 This drawing is the property of the  
 architect and is not to be used for  
 any other purpose without the  
 written consent of the architect.

# Signature Theatre

**Perishing Square  
 Signature Center**  
 450 W. 42nd Street  
 New York, NY 10018  
 212-495-1919

**The Diamond  
 Theatre**

*Carrollplan*

Contractor	Drew McKinnon
Architect	Carrollplan
Project No.	Andover 1, New
Date	September 15, 2022
Scale	1/2" = 1'-0"
Approved By	

Plate # \_\_\_\_\_  
 of \_\_\_\_\_

Original Theatre Framing from the  
 Andover 1, New  
 as September 15, 2022

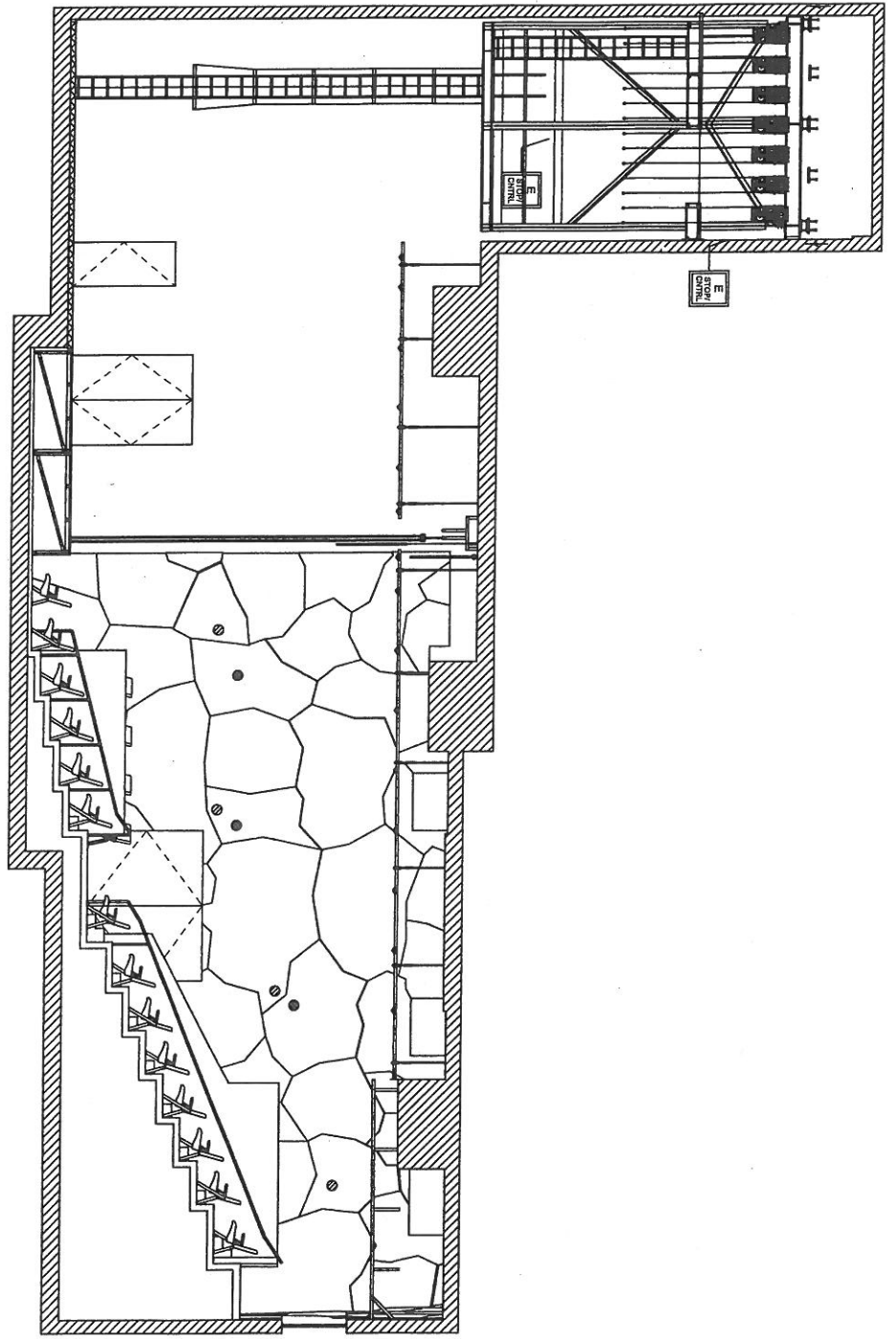

**Diamond Theatre North**  
 1 - Section taken at the level of the floor of the  
 2 - Section taken at the level of the ceiling of the  
 3 - Section taken at the level of the roof of the  
 4 - Section taken at the level of the ground outside the wall

# Signature Theatre

Perkins Square  
 Signature Center  
 480 W. 42nd Street  
 New York, NY 10036  
 212-981-1192

The Diamond  
 Theatre

Cl. Section  
 Looking North

Architect	Dave McKinn
Project	Diamond Theatre
Date	March 1, 2002
Author	September 15, 2002
Typicality	
Scale	1/8" = 1'-0"

Plate # \_\_\_\_\_  
 of 1

Original: Theater Drawing, Diamond  
 Theater, New York  
 as September 15, 2002